



8 GHz N LATCHING S.P.8 T. SWITCH

OPTIONS :

**R F CHARACTERISTICS**

NUMBER OF WAYS : 8  
 FREQUENCY RANGE : 0 - 8 GHz  
 IMPEDANCE : 50 Ohms

|                 |         |         |
|-----------------|---------|---------|
| FREQUENCY (GHz) | 0 - 3   | 3 - 8   |
| V.S.W.R <=      | 1.30    | 1.50    |
| INSERT. LOSS <= | 0.30 dB | 0.50 dB |
| ISOLATION >=    | 80 dB   | 70 dB   |
| AVER. POWER (*) | 300 W   | 200 W   |

**ELECTRICAL CHARACTERISTICS**

ACTUATOR : LATCHING  
 NOMINAL CURRENT AT 25°C (±10%) : 320 mA / RESET : 2560 mA (\*\*)  
 ACTUATOR VOLTAGE (Vcc) : 12V (10.2 to 13V) / NEGATIVE COMMON  
 TERMINALS : solder pins (250 deg.C max./30 sec.)

**MECHANICAL CHARACTERISTICS**

CONNECTORS : N female per MIL-C 39012  
 LIFE : 2.000.000 cycles per position  
 SWITCHING TIME (nominal voltage;25°C) : < 15 ms  
 CONSTRUCTION : splashproof  
 WEIGHT : < 680 g

**ENVIRONMENTAL CHARACTERISTICS**

OPERATING TEMPERATURE RANGE (°C) : -40 , +85  
 STORAGE TEMPERATURE RANGE (°C) : -55 , +85

(\* : average power at 25°C per RF path)  
 (\*\* RESET : supply voltage time 1sec. max./duty cycle 10%)

4112-9212 This information is given as an indication. In the continual goal to improve our products, we reserve the right to make any modifications judged necessary

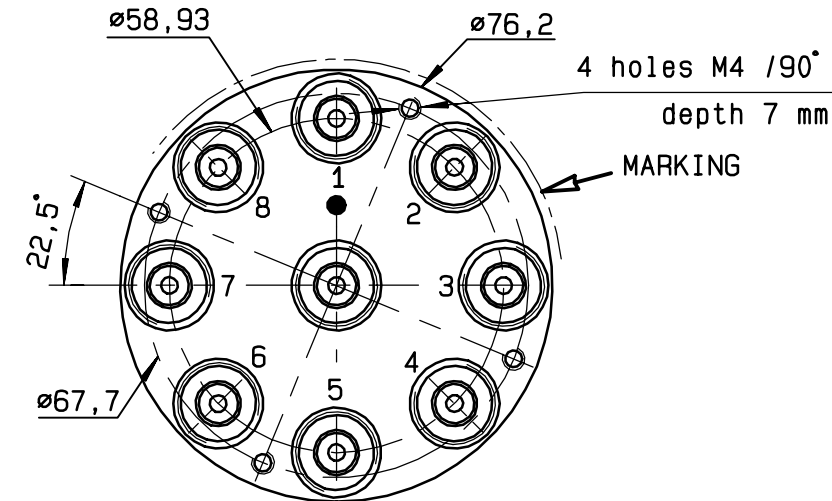

| Voltage   | RF continuity  |
|-----------|----------------|
| -C +RESET | All ports open |
| -C +1     | IN ↔ 1         |
| -C +2     | IN ↔ 2         |
| -C +3     | IN ↔ 3         |
| -C +4     | IN ↔ 4         |
| -C +5     | IN ↔ 5         |
| -C +6     | IN ↔ 6         |
| -C +7     | IN ↔ 7         |
| -C +8     | IN ↔ 8         |

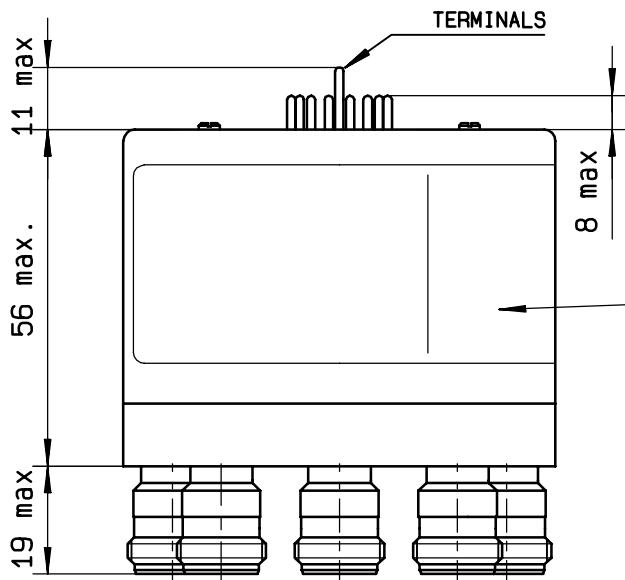

MARKING TOP VIEW (TERMINALS)

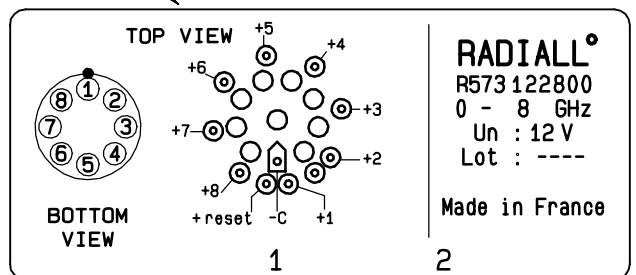

**SCHEMATIC DIAGRAM**

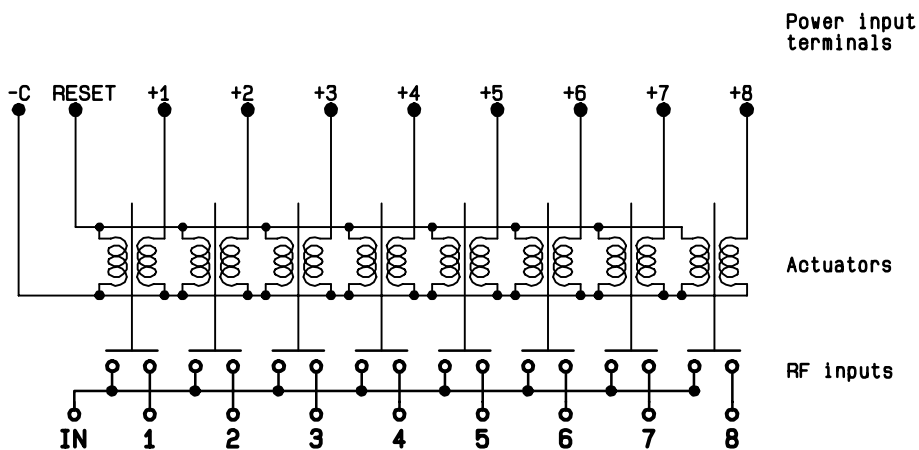

Power input terminals

Actuators

RF inputs

This information is given as an indication. In the continual goal to improve our products, we reserve the right to make any modifications judged necessary

4113-9212